

James S Bates Architect, PLLC

James S Bates Architect, PLLC celebrated its two-year anniversary in January of 2014. In addition to developing its own project list, the firm has formed relationships with architectural professionals within the Northern Michigan region. The focus of the firm remains to be custom residential projects, however it has expanded to include civic/municipal and commercial projects with clients that includes the Michigan Department of Natural Resources, the Gaylord Otsego Club and Resort, Villa de Charlevoix, Challenge Mountain, and Our Savior Lutheran Church in Gaylord.

Following a successful second year, and a relocation to Roscommon Michigan, the firm welcomes the new year and the continued opportunity to enhance the built environment. The following are a few highlighted projects that were developed over the past year.



Michigan Department of Natural Resources Forest Fire Experiment Station Replacement Roscommon, Michigan

The Principal and Project Architect for a 19,000 sq. ft., \$2,000,000 facility which houses the design and manufacturing operations of forest fire fighting vehicular equipment. The facility replaces the original outdated building that served the department for over 80 years. Construction of the facility began in the fall of 2013.

Otsego Club & Resort Halfway House on the Tribute Gaylord, Michigan

The Principal and Project Architect for a 722 sq. ft. Halfway House at the Tribute Golf Course. The course is a Robbins/Koch design, and is a 1,100 acre tour of the majestic Sturgeon River Valley. The building will be nestled into a hillside and taking advantage of the southern exposure to bring natural light into the building. Construction of the facility is to begin in the spring of 2014.



Single Family Residence Vistas of Walloon, Walloon Lake, Michigan

The Principal and Project Architect for a 5,400 sq. ft. residence in a tranquil development within walking distance of Walloon Lake. The residence will be finished with natural cedar lap and shingle siding which will complement its northern Michigan surroundings. Construction is set to begin in the spring of 2014.

James S Bates Architect, PLLC



Torch Lake Addition

In partnership with Indesign of Charlevoix, Mr. Bates was the designer of 2,000 sq. ft. of additions to an existing 2,250 sq. ft. single family residence within steps of Torch Lake. The main three-story addition included bedrooms on the lower level, an office, garage and entrance on the middle level, and an office on the third and tower level. Construction has begun and will be completed in the spring of 2014.



Lake Charlevoix Residence

In partnership with Indesign of Charlevoix, Mr. Bates was the co-designer of 3,000 sq. ft. single family residence on the shore of Lake Charlevoix. The main spaces, including all the bedrooms, living room, family room, dining room, and sun room, will have prime views of the lake. Construction has begun and will be completed in the spring of 2014.

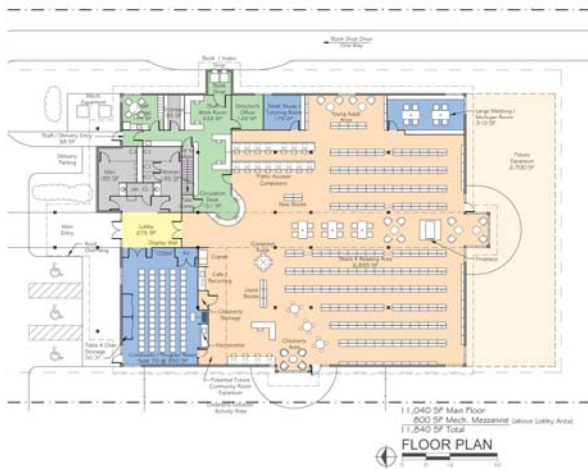

Roscommon Area District Library
Roscommon, Michigan

In partnership with Thomas I. O'Brien Architect, Inc. of Roscommon, Mr. Bates developed the interior of the 9,000 sq. ft. Library. The use of natural cedar columns, beams and ceilings, will bring a warm feeling to the interior of the facility. Construction has begun and will be completed in February of 2014.